



WWW.USTRUCKBODY.COM



ALUMINUM VAN BODY

BODIES HIGHER
HELD TO A STANDARD

U.S. Truck Body offers dry freight van body solutions that give our customers a competitive advantage. Our bodies are built around customer needs and able to withstand the most demanding conditions, at the lowest total cost of ownership.

The aluminum sheet and post body is the economical standard in dry freight van bodies. Our aluminum bodies are custom built around specific needs, chassis, and businesses. Length, height, and width are all customizable with a variety of bumpers or liftgates, rear and side doors, and numerous interior options.

QUALITY BUILT IN

We're committed to providing our customers with a product that will meet or exceed all requirements and expectations, and confident that our body will outlast the competition. Attention to detail is what separates us from the competition, and our quality is in the details.



FROM THE TOP

Our unique two-piece roof-rail design, aerodynamic front radius, and aluminum corner castings deliver a strong, sleek, and sealed roof that is easily replaceable if damaged.

TO THE BOTTOM

Full length domestic hardwood, weatherproof undercoating, and an anti-shift mounting process creates security and durability while keeping the elements out.



We are dedicated to customer needs and feedback, which has driven design improvements over the years.

From our manufacturing process to our materials, ordinary areas of vulnerability are now strengths.

1. Stainless Steel Rear Frame

A 12 gauge stainless steel rear frame comes standard. All corners are internally reinforced for strength, as well as externally gusseted at the top corners. This frame will look good throughout the life of the body, without having to worry about chipping paint or corrosion.

2. One Of A Kind Roof

Our unique two-piece roof-rail design not only increases strength, it also allows for an easy replacement (if damaged) without disturbing the front, sides, and rear structure. Durable, aluminum castings on each corner increase strength while the front "zephyr" improves aerodynamics. Aluminum or translucent available.

3. LED Clearance Lights

Brighter, longer lasting LED clearance lights are standard and FMVSS-108 compliant. LED tail lights are also used with the recessed taillight option.

4. DuraPlate® Swing Doors

Our side and rear swing doors are an industry benchmark. We custom build each door using 13mm thick DuraPlate® panels exclusively for durability. Stainless steel bar lock hardware, aluminum hinges, and replaceable stainless steel pins are installed creating an extremely strong door that's corrosion resistant.

5. Corrosion Resistant Hardware

The swing doors are not the only part of the truck body with corrosion resistant hardware – the exterior is assembled using only aluminum and stainless fasteners.

6. Superior Strength Front Wall

With a 7 post front wall construction and extruded aluminum radius corners, our walls don't compromise strength. When scuff plate is optioned, we extend it below the floor and weld to the front cross member to withstand abuse from forklifts.

7. Domestic Hardwood Floors

We use only 1-1/8" or thicker laminated domestic hardwood, which runs the full length of the body, to ensure durability. No need to worry about delamination or warping down the road.

8. Weatherproof Undercoating

To protect from the harsh environment, after the body is mounted and wired, a weatherproof undercoating is applied to seal the interior and protect the underside.

U.S. TRUCK BODY ADVANTAGES

QUICK RESPONSE ON QUOTES

Same day or always within 24 hours. Call 800-433-0843 or fill out our convenient form online at www.ustruckbody.com.

PERSONAL SALES SUPPORT

An internal sales consultant tracks daily production to keep you better informed of your truck body order.

FLEXIBILITY

Need something custom? We build to order and are ready to build exactly what you need.

STANDARD LENGTH (INSIDE) 10' - 28'

(Outside length is 6 3/8" longer than inside dimension)

Custom sizes available.

SHORT LEAD TIMES

We work hard to keep short lead times and meet tight deadlines. Whether it's completely custom or a stock body, you can expect a quick turnaround.

PREMIUM QUALITY

We use the best materials, optimal manufacturing practices, along with our 60+ years of experience and highly trained workers.



STANDARD WIDTH AND HEIGHT

MODEL #	INSIDE		OUTSIDE		REAR DOOR OPENING	
	Width	Height	Width	Height	Width	Height
VA-78	93"	78"	96"	85"	88"	72 - 1/2"
VA-84	93"	84"	96"	91"	88"	78 - 1/2"
VA-90	93"	90"	96"	97"	88"	84 - 1/2"
VA-96	93"	96"	96"	103"	88"	90 - 1/2"
VA-102	93"	102"	96"	109"	88"	96 - 1/2"
VA-108	93"	108"	96"	115"	88"	102 - 1/2"

Notes: A. Inside length based on 1/2" plywood lining on front wall, and roll-up rear door.
B. For full rear swing-type doors, add 3 1/2" to inside body length.
C. Inside width is measured from post-to-post without lining. Add 6" for 102" O.D.
D. Outside height of body is measured excluding longitudinals.
E. Rear door openings are same for roll-up or swing type doors.

USA
TRUCK BODYTM
WWW.USTRUCKBODY.COM



FRP VAN BODY

BODIES HIGHER
HELD TO A STANDARD

U.S. Truck Body offers dry freight van body solutions that give our customers a competitive advantage. Our bodies are built around customer needs and able to withstand the most demanding conditions, at the lowest total cost of ownership.

Our FRP Body is an alternate construction method that has some unique advantages when compared to a standard aluminum body. FRP construction results in an extremely durable and rigid construction, along with additional space due to the absence of wall posts.

FIBERGLASS REINFORCED PLYWOOD

FRP is an extremely durable panel that is constructed of plywood, reinforced with fiberglass, and then gel coated. 5/8" plywood core is our standard size, however multiple thicknesses are available to fit your application.



ADVANTAGES

- Strongest body construction available
- Smooth exterior that's great for graphic applications
- Brighter interior with white walls
- Dent resistant
- Additional cubic feet over aluminum sheet and post
- Non-corrosive
- Easy to clean



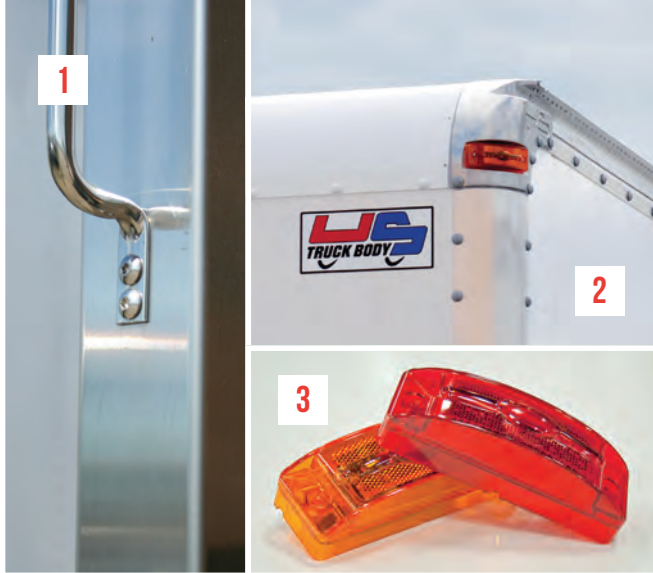

We are dedicated to customer needs and feedback, which has driven design improvements over the years.

From our manufacturing process to our materials, ordinary areas of vulnerability are now strengths.

1. Stainless Steel Rear Frame

A 12 gauge stainless steel rear frame comes standard. All corners are internally reinforced for strength, as well as externally gusseted at the top corners. This frame will look good throughout the life of the body, without having to worry about chipping paint or corrosion.

2. One Of A Kind Roof

Our unique two-piece roof-rail design not only increases strength, it also allows for an easy replacement (if damaged) without disturbing the front, sides, and rear structure. Durable, aluminum castings on each corner increase strength while the front "zephyr" improves aerodynamics. Aluminum or translucent available.

3. LED Clearance Lights

Brighter, longer lasting LED clearance lights are standard and FMVSS-108 compliant. LED tail lights are also used with the recessed taillight option.

4. DuraPlate® Swing Doors

Our side and rear swing doors are an industry benchmark. We custom build each door using 13mm thick DuraPlate® panels exclusively for durability. Stainless steel bar lock hardware, aluminum hinges, and replaceable stainless steel pins are installed creating an extremely strong door that's corrosion resistant.

5. Corrosion Resistant Hardware

The swing doors are not the only part of the truck body with corrosion resistant hardware – the exterior is assembled using only aluminum and stainless fasteners.

6. Superior Strength Front Wall

Extruded aluminum radius corners with 5/8" core FRP make our front walls extremely durable. When scuff plate is options, we extend it below the floor and weld to the understructure to withstand even the toughest abuse.

7. Domestic Hardwood Floors

We use only 1-1/8" or thicker laminated domestic hardwood, which runs the full length of the body, to ensure durability. No need to worry about delamination or warping down the road.

8. Weatherproof Undercoating

To protect from the harsh environment, after the body is mounted and wired, a weatherproof undercoating is applied to seal the interior and protect the underside.

U.S. TRUCK BODY ADVANTAGES

QUICK RESPONSE ON QUOTES

Same day or always within 24 hours. Call 800-433-0843 or fill out our convenient form online at www.ustruckbody.com.

PERSONAL SALES SUPPORT

An internal sales consultant tracks daily production to keep you better informed of your truck body order.

FLEXIBILITY

Need something custom? We build to order and are ready to build exactly what you need.

STANDARD LENGTH (INSIDE) 10' - 28'

(Outside length is 6 3/8" longer than inside dimension)

Custom sizes available.

SHORT LEAD TIMES

We work hard to keep short lead times and meet tight deadlines. Whether it's completely custom or a stock body, you can expect a quick turnaround.

PREMIUM QUALITY

We use the best materials, optimal manufacturing practices, along with our 60+ years of experience and highly trained workers.



STANDARD WIDTH AND HEIGHT

MODEL #	INSIDE		OUTSIDE		REAR DOOR OPENING	
	Width	Height	Width	Height	Width	Height
VA-78	94.5"	78"	96"	85"	88"	72 - 1/2"
VA-84	94.5"	84"	96"	91"	88"	78 - 1/2"
VA-90	94.5"	90"	96"	97"	88"	84 - 1/2"
VA-96	94.5"	96"	96"	103"	88"	90 - 1/2"
VA-102	94.5"	102"	96"	109"	88"	96 - 1/2"
VA-108	94.5"	108"	96"	115"	88"	102 - 1/2"

Notes: A. Inside length measured from inside front FRP panel to inside surface of roll-up rear door.
B. For full rear swing-type doors, add 3 1/2" to inside body length.
C. Inside width is measured from panel to panel. Add 6" for 102" O.D.
D. Outside height of body is measured excluding longitudinals.
E. Rear door openings are same for roll-up or swing type doors.



Freight Plate Van Body

Maximize your capacity, value, and durability while extending van body life and lowering operating costs.



- DuraPlate® panels provide exceptional strength and durability
- Shiplap seam, post-less design - ideal surface for graphics
- Absence of wall posts maximizes interior space, adding approximately 3" of width inside the body
- White interior panels provides added brightness, better visibility, and are easily cleaned
- DuraPlate® panels eliminate the need to maintain and replace plywood liners
- DuraPlate® swing doors and stainless steel bar lock hardware (all standard) built for rugged applications
- Low cost of ownership; added overall value

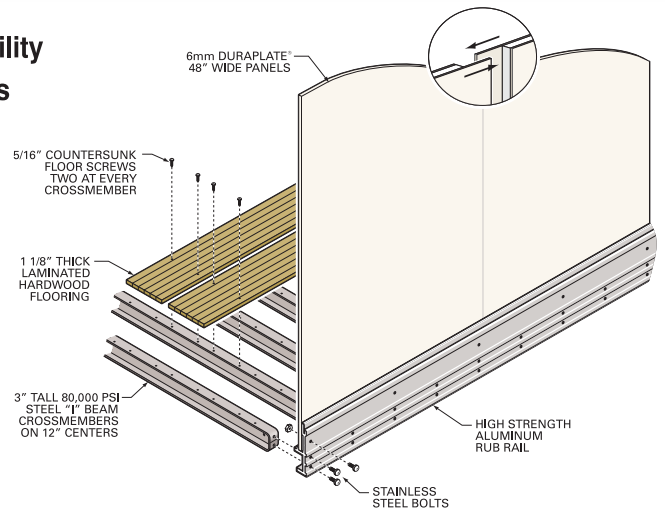

Standard Length (Inside) 10' - 28' *Outside length is 6 3/8" longer than inside dimension.*

Notes: A. Inside length measured from inside front panel to inside surface of roll-up rear door.
 B. For full rear swing-type doors, add 3 1/2" to inside body length.

Standard Width and Height for 96" O.D. *(Add 6" to widths for 102" O.D. wide models)*

MODEL #	INSIDE		OUTSIDE		REAR DOOR OPENING	
	Width	Height	Width	Height	Width	Height
FP-78	95"	78"	96"	85"	88"	72 1/2"
FP-84	95"	84"	96"	91"	88"	78 1/2"
FP-90	95"	90"	96"	97"	88"	84 1/2"
FP-96	95"	96"	96"	103"	88"	90 1/2"
FP-102	95"	102"	96"	119"	88"	96 1/2"

Notes: C. Outside height of body is measured excluding longitudinals.
 D. Rear door openings are same for roll-up or swing type doors.

Freight Plate Van Body Features

Front: Aerodynamic design with "Zephyr" front nose, 12" radius with heavy duty aluminum corner castings (not fiberglass), 5" front corner radius utilizing 1/8" rugged aluminum extrusion, not roll formed.

Front & Side Walls: Front wall and sidewalls consist of 6mm thick DuraPlate® panels – efficient, light-weight, and incredibly strong design that provides exceptional resistance to damage, leaks, and corrosion. Panels are composed of 80,000 psi yield steel skins with a polyethylene core. The bond between the skins and core form an added barrier that won't deteriorate and is impervious to water.

Doors: Quality DuraPlate® construction – 13 mm thick, 80,000 psi yield skins, custom built side or rear swing doors to ensure a precise fit and positive closing.

Hinges: Premium appearance, heavy-duty extruded aluminum hinges for long term use with stainless steel replaceable pins.

Bar Locks: All stainless steel hardware on rear and side swing doors.

Roof: One-piece aluminum (.032 in.), tension-fitted and bonded to roof bows. Roof assembly is bolted to top rail structure for easy removal and repair.

Roof Bows: Roll-formed 18 gauge galvanized steel, anti-sag configuration, located on 24" centers.

Rear Frame: 11 gauge galvanneal steel with reinforcement at all stress points. Tapered rear threshold.

Crossmembers: Hi-tensile steel 3" steel I-beams on 12" centers, double bolted to the high strength extruded aluminum rub rail using stainless steel bolts. Alternating crossmembers are gusseted to longitudinal with steel wheel pan supports over the wheels.

Longitudinals: Structural steel "C" channel (height dependent on chassis mounting requirements).

Floor: 1 1/8" laminated hardwood, each board installed with two 5/16" countersunk screws at each crossmember and securely joined to adjacent boards by shiplap joints and an added crusher bead to ensure a tight seal.

Interior Light: Roof-mounted dome light, with switch on wall inside rear door opening.

Exterior Lights: Marker lights recessed in roof cove with exterior wiring in protective groove. All connectors shielded from moisture by heat-shrink insulators.

Reflectors: Installed as required to comply with FMVSS.

Undercoating: Petrol base (not paint) on full understructure.

Mounting: Body mounted on customer-supplied chassis. Hardwood filler strips are steel-banded to top of chassis frame rails. Zinc plated U-bolts are placed through crush pipes (between frame rails) to hold body in place more securely and to prevent over-tightening and bending of frame rails. Structural steel "side-standards" are welded to longitudinals to prevent shifting side-to-side.

Mudflaps: "U.S. Truck Body," premium anti-sail

Options

Translucent Roof

Logistics – E-track (surface mounted)

Scuff Plate – 12 ga., 14 ga., 1/8" steel tread plate, aluminum tread plate

Side Doors – All DuraPlate construction. Standard 45" x 76" swing doors come with stainless steel bar locks

Rear Doors – Roll-up or Two-Panel Swing Doors - full opening with DuraPlate construction used on swing doors

Floors – 1 1/8" or 1 3/8" oak, fill and sand screw holes, polyurethane varnish, logistic track, bull rings

Bumper Options: ICC Bumper, Bumper Step - open face, close face, ICC Bumper - with floor extension (6" and 12"), 12" Split Dock Bumper - with two steps, Chicago style

Liftgate Installations – for all makes and models

Stainless Steel – front corners, roof radius, rear frame, hinges, and bright polished front corner castings

LED Lights



U.S. Truck Body • 1807 N. Bloomington Street • Streator, IL 61364
Phone: 1-800-443-0843 • 1-815-672-3211 • Fax: 1-815-672-1490
E-mail: sales@ustruckbody.com • Web: www.ustruckbody.com



Form No. 2/08